

SCALE: 1"=30'

- EXISTING LEGEND**
- PK NAIL
 - BENCHMARK
 - COTTON SPINDLE SET
 - IRON PIPE FOUND
 - IRON ROD FOUND
 - IRON ROD WITH CAP FOUND
 - IRON ROD WITH CAP SET
 - NAIL FOUND
 - NAIL SET
 - RTK POINT
 - CALCULATED POINT
 - GPS POINT
 - LANDHOOK
 - LIGHTPOLE
 - PARKING METER
 - ELECTRIC MANHOLE
 - ELECTRIC METER
 - BOLLARD
 - SIGN POST
 - TRASH CAN
 - STORM DRAIN MANHOLE
 - STORM DRAIN INLET
 - TREE W/TREE NUMBER
 - TELEPHONE JUNCTION BOX
 - TELEPHONE MANHOLE
 - FIRE HYDRANT
 - IRRIGATION CONTROL VALVE
 - WATER METER
 - WATER VALVE
 - WASTEWATER MANHOLE
 - WATER LINE
 - RECLAIMED WATER
 - WASTEWATER LINE
 - STORM DRAIN LINE
 - TRAFFIC SIGNAL LINE
 - OVERHEAD ELECTRIC LINE
 - OVERHEAD UTILITY LINE
 - CURB AND GUTTER
 - ASPHALT LINE
 - CONCRETE PAVEMENT
 - APPROXIMATE 100 YEAR FLOOD PLAIN
 - PLAT RECORDS TRAVIS CO, TX
 - DEED RECORDS TRAVIS CO, TX
 - REAL PROPERTY RECORDS TRAVIS CO, TX
 - OFFICIAL PUBLIC RECORDS TRAVIS CO, TX

NOTES:
 COORDINATE BASIS: TEXAS STATE PLANE, CENTRAL ZONE, NAD 83(2011), ADJUSTED TO SURFACE BY MULTIPLYING BY THE SURFACE ADJUSTMENT FACTOR OF 1.00006. ALL DISTANCES AND COORDINATES SHOWN ARE SURFACE VALUES.

VERTICAL BASIS: NAVD88
 BM:1 SQUARE CUT IN TOP OF CURB, NORTH SIDE OF 9TH ST. AT CENTERLINE OF BRIDGE OVER SHOAL CREEK. ELEV 469.39'

BM:2 SQUARE CUT IN TOP OF CURB, NORTH SIDE OF 10TH ST. AT CENTERLINE OF BRIDGE OVER SHOAL CREEK. ELEV 473.21'

BM:3 'X' CUT IN NORTHEAST CORNER OF CONCRETE PICNIC TABLE PAD, THE EAST MOST OF TWO PICNIC TABLES IN PARK, APPROX 175' SOUTH OF 10TH ST. ELEV. 466.41'

THE LOCATIONS AND SIZE OF EXISTING UNDERGROUND UTILITIES SHOWN ON THIS DRAWING ARE FROM RECORDS WHICH MAY NOT BE ENTIRELY ACCURATE AND FROM SURFACE EVIDENCE AS SURVEYED ON THE GROUND.

ONLY 4" TREES AND LARGER ARE SHOWN ON THIS DRAWING.

PART OF THIS TRACT IS WITHIN THE 100 YEAR FLOOD PLAIN ACCORDING TO FLOOD INSURANCE RATE MAP PANEL No. 48453C0445H AND 48453C0465H, DATED SEPTEMBER 26, 2008.

CURVE TABLE

CURVE	RADIUS	DELTA	ARC	BEARING	CHORD
C1	364.81' (364.81')	2'21'41" (2'21'41")	15.04' (15.04')	S69°52'33"E (N67°15'16"W)	15.03' (15.03')
C2	430.02' (430.02')	3'06'56" (3'06'56")	23.38' (23.38')	S70°15'10"E (N67°37'53"W)	23.38' (23.38')
C3	759.81' (759.81')	11'59'42" (11'59'42")	159.07' (159.07')	N75°42'54"W	158.78'

LINE TABLE

LINE	BEARING	LENGTH
L1	S71° 03' 23"E (N68°26'05"W)	56.40'
L2	S73° 31' 05"E (S70°55'0E)	39.41'
L3	S34° 22' 43"E	18.00'
L4	S20° 16' 57"W	10.00'
L5	S60° 33' 47"E	6.07'

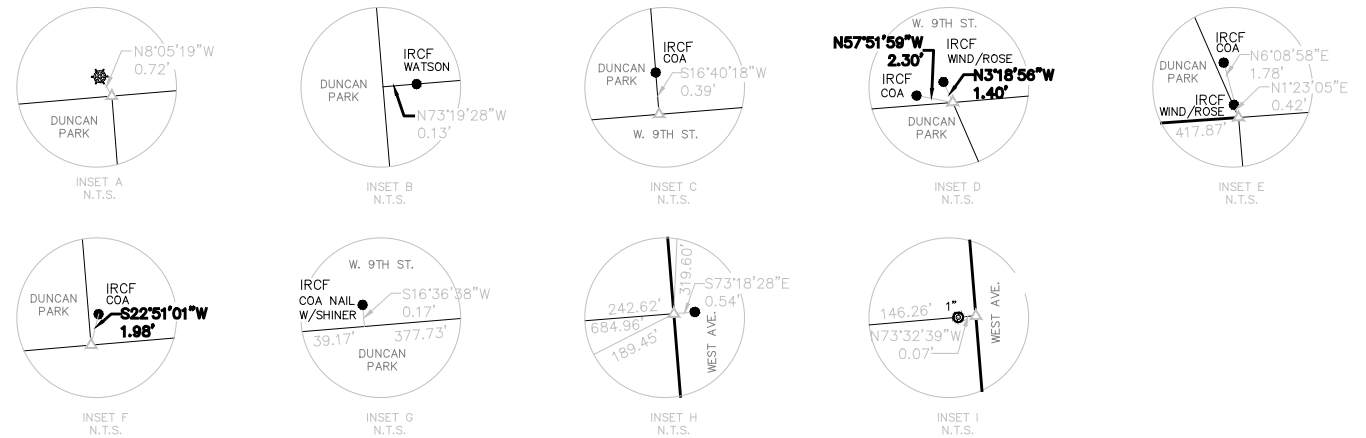

mwm Design Group
 305 East Huntland Drive
 Suite 200
 Austin, Texas 78752
 p: 512.453.0767
 f: 512.453.1734
 TBLS Firm Registration
 No. 10065600

NO.	DATE	DESCRIPTION	BY

BOUNDARY AND TOPOGRAPHIC SURVEY
 DUNCAN PARK
 AUSTIN, TEXAS

DATE: 15 AUG 14
 JOB NO: 023-73D
 FILE: 02373D.DWG
2
 OF 3